

vtech[®]

Parent's Guide

3-in-1 Step & Roll Motorbike™



91-003840-000 (US) (CA)

INTRODUCTION

Thank you for purchasing the **3-in-1 Step & Roll Motorbike™**.

Hop on the motorbike that's packed with fun and learning! Pretend to visit places in the community while learning about colors with songs and music. Walk, ride and balance with the **3-in-1 Step & Roll Motorbike™**.

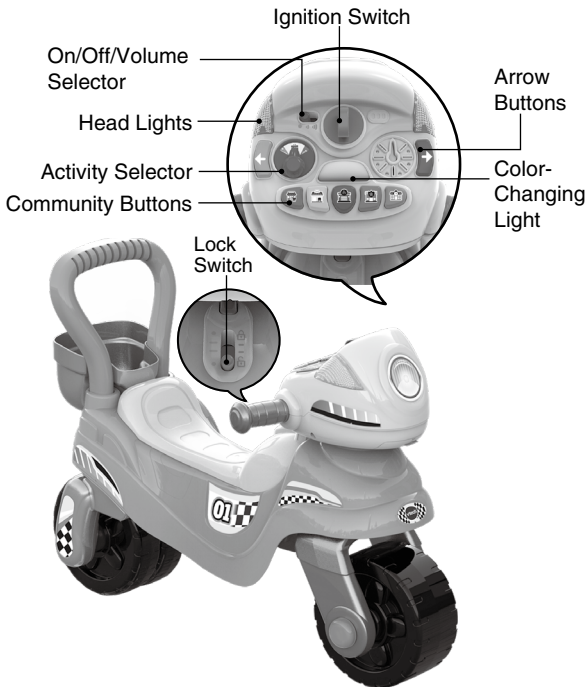

INCLUDED IN THIS PACKAGE

- 3-in-1 Step & Roll Motorbike™



- Interactive Dashboard

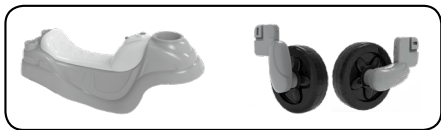

- Vehicle body
- Two back wheels

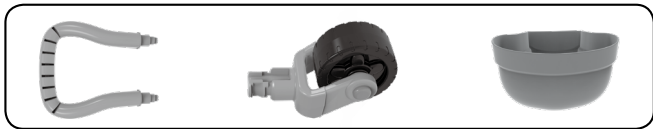

- Back handle
- Front wheel
- Storage basket



- Label sheet
- Parent's guide

WARNING

All packing materials such as tape, plastic sheets, packaging locks, removable tags, cable ties and packaging screws are not part of this toy, and should be discarded for your child's safety.

NOTE

Please keep this parent's guide as it contains important information.

ATTENTION

Pour la sécurité de votre enfant, débarrassez-vous de tous les produits d'emballage tels que rubans adhésifs, feuilles de plastique, attaches, étiquettes et vis d'emballage. Ils ne font pas partie du jouet.

NOTE

Il est conseillé de conserver ce guide des parents car il comporte des informations importantes.

Unlock the Packaging Lock

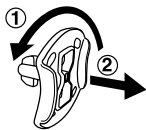

- ① Rotate the packaging lock counterclockwise 90 degrees.
- ② Pull out the packaging lock and discard.

WARNING

The maximum weight for this product is 42 pounds. Insufficient strength. It is not recommended for children older than 36 months. Protective equipment should be worn. Regularly check for signs of wear or tear on the snap in or locking devices. If damaged do not use until repaired or replaced.

ATTENTION

Ce jouet ne doit pas être utilisé par des enfants de plus de 36 mois. Résistance insuffisante. 42lbs max. A utiliser avec un équipement de protection. Vérifier régulièrement les signes d'usure ou de cassure dans les dispositifs de fermeture. Si le jouet est endommagé, ne pas l'utiliser tant qu'il n'est pas réparé ou remplacé.

GETTING STARTED

Battery Removal and Installation

1. Make sure the unit is turned **Off**.
2. Find the battery cover located on the bottom of the interactive dashboard and use a screwdriver to loosen the screw and open the battery cover.
3. Remove old batteries by pulling up on one end of each battery.
4. Install 2 new AA (LR6/AM-3) batteries following the diagram inside the battery box.
5. Replace the battery cover and tighten the screw to secure.

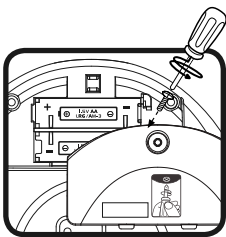

BATTERY NOTICE

- Use new alkaline batteries for maximum performance.
- Use only batteries of the same or equivalent type as recommended.
- Do not mix different types of batteries: alkaline, standard (carbon-zinc) or rechargeable, or new and used batteries.
- Do not use damaged batteries.
- Insert batteries with the correct polarity (+ and -).
- Do not short-circuit the battery terminals.
- Remove exhausted batteries from the toy.
- Remove batteries during long periods of non-use.
- Do not dispose of batteries in fire.
- Do not charge non-rechargeable batteries.
- Remove rechargeable batteries from the toy before charging (if removable).
- Rechargeable batteries are only to be charged under adult supervision.

MISE EN GARDE

- Utiliser des piles alcalines neuves pour des performances maximales.
- Les piles fournies avec le produit permettent de tester le jouet en magasin mais ne sont pas des piles longue durée.
- Seules des piles du type recommandé doivent être utilisées.
- Ne pas mélanger différents types de piles ou d'accumulateurs, ne pas mélanger des piles ou des accumulateurs neufs avec des usagés.
- Ne pas utiliser des piles ou des accumulateurs endommagés.
- Mettre en place les piles ou les accumulateurs en respectant les polarités + et -.
- Ne pas mettre les bornes d'une pile ou d'un accumulateur en court-circuit (en reliant directement le + et le -).
- Enlever les piles ou les accumulateurs usagés du jouet.
- Retirer les piles ou les accumulateurs en cas de non-utilisation prolongée.
- Ne les jeter ni au feu ni dans la nature.
- Ne pas tenter de recharger des piles non rechargeables.
- Enlever les accumulateurs du jouet pour les recharger.
- Les accumulateurs ne doivent être chargés que sous la surveillance d'un adulte.

LABEL APPLICATION

Please securely stick the labels to the toy as indicated below:

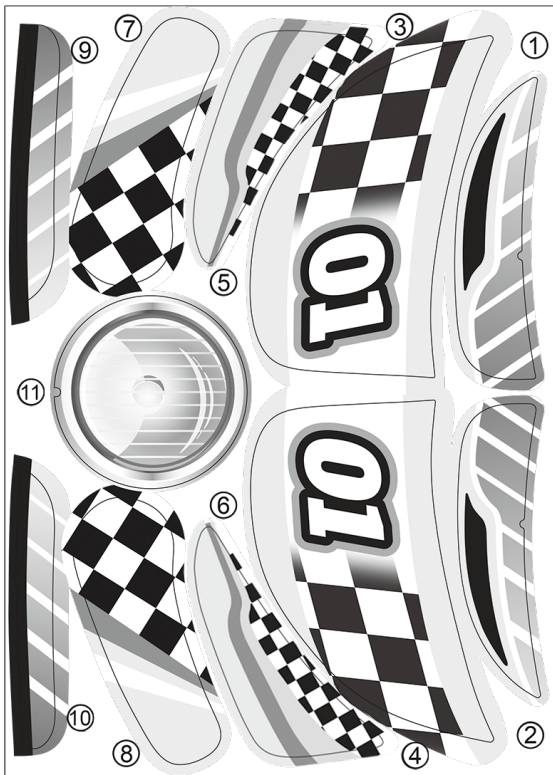

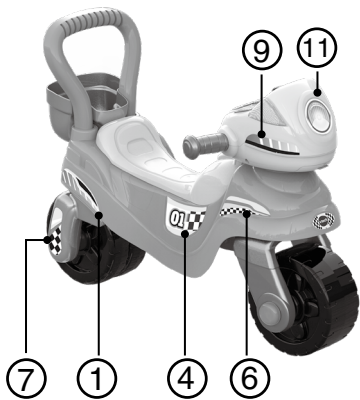

Three Ways to Play and Ride

Use the back handle as a grip for little ones learning to walk. Progress to a three-wheeled motorbike and then to a two-wheeler when they are ready to balance.

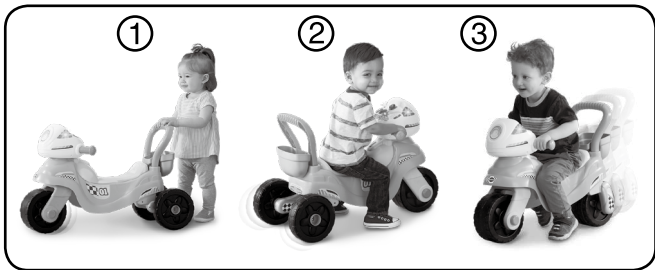

ASSEMBLY INSTRUCTIONS

With the **3-in-1 Step & Roll Motorbike™**, safety comes first. Adult assembly required. For your child's safety, do not let them play with this toy until it is fully assembled.

1. Insert the **Interactive Dashboard** into the slot on the top of the vehicle body. You will hear the pieces snap together when connected properly.

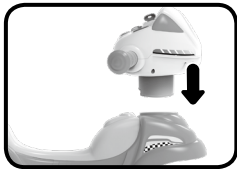

2. To assemble the back wheels in the tricycle position, insert each of the wheels into the slots on the bottom of the vehicle body so the tricycle labels are visible. You will hear the pieces snap together when connected properly.

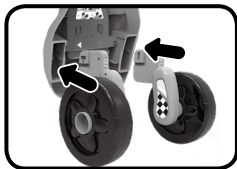

3. To assemble the back wheels in the motorcycle position, insert each of the wheels into the slots on the bottom of the vehicle body so the motorcycle labels are visible. You will hear the pieces snap together when connected properly.

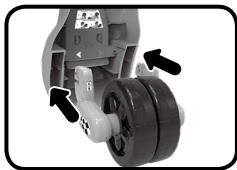

4. To use the motorbike as a push-along walker with the wheels in tricycle position, slide the **Locking Switch** to the locked position so the front wheel does not turn left or right, providing a more stable walker. When using the motorbike as a ride-on toy, slide the **Locking Switch** to the unlocked position.



5. To remove the back wheels, slide the wheel locks inward to unlock the wheels.

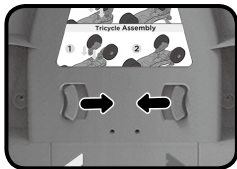

6. To assemble the front wheel, insert the wheel into the slot on the bottom of the vehicle body. You will hear the pieces snap together when connected properly.

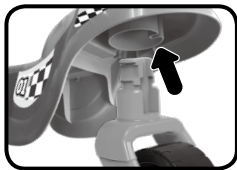

7. Insert the back handle into the two slots on the back of vehicle body. You will hear the pieces snap together when connected properly.

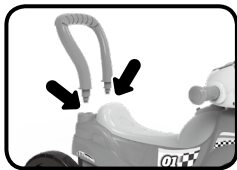

8. Insert the storage basket into the slot between the back handle as illustrated.

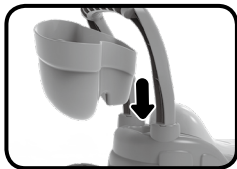

Once you've completed the above steps, you are ready to play!

PRODUCT FEATURES

1. On/Off/Volume Selector

To turn the unit **On**, slide the **On/Off/Volume Selector** to the Low volume **||** or the High volume **|||** position. You will hear a sound and a phrase. To turn the unit **Off**, slide the **On/Off/Volume Selector** to the Off **●** position.

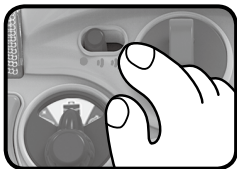

2. Activity Selector

Turn the **Activity Selector** to choose a mode of play. The three modes of play include Learning mode, Adventure mode and Music mode.

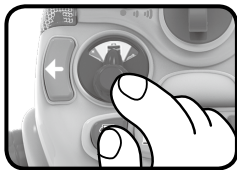

3. Automatic Shut-Off

To preserve battery life, the **3-in-1 Step & Roll Motorbike™** will automatically shut off several minutes without input. The unit can be turned on again by adjusting the **Activity Selector** or sliding the **On/Off/Volume Selector** or turning the **Ignition Switch**.

NOTE

If the unit powers down or if the light fades out during play, please install a new set of batteries.

ACTIVITIES

1. Community Buttons

Press the **Community Buttons** to learn about colors and locations around town in Learning mode. In Adventure mode you will hear a variety of phrases to encourage imaginative play. In Music mode you will hear songs. The lights will flash with the sounds.



2. Ignition Switch

Turn the **Ignition Switch** to hear realistic engine sounds and imaginative phrases. The lights will flash with the sounds.

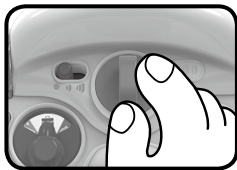

3. Arrow Buttons

Press the **Arrow Buttons** to learn about colors and hear interactive phrases and melodies. The lights will flash with the sounds.

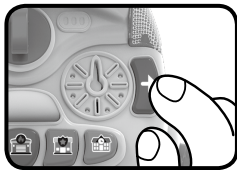

MELODIES

1. Oh My Darling Clementine
2. Did You Ever See a Lassie?
3. Humpty Dumpty
4. London Bridge Is Falling Down

SONG LYRICS

Song 1

To market, to market,
To buy some fresh fruit.
Apples and oranges and
Pears all taste good.

Song 2

Let's go to the grocery store,
The grocery store, the grocery store.
Let's go to the grocery store.
I need to buy some food.

Song 3

A-Tisket, a-tasket,
A letter in my basket.
I zoom around town, I deliver the mail,
To all my friends and family.

Song 4

Look at me, I'm going to town,
Riding on my motorbike.
First stop is the post office,
Where I'll mail a letter.

Song 5

Jump on to the fire truck,
Don't forget to grab the hose.
Spray the water on the fire,
Out it goes!

Song 6

Hurry, hurry, hurry, hurry!
Ding, ding, ding! Ding, ding, ding!
Someone needs our help,
Someone needs our help!
Off we go! Off We go!

Song 7

I'm zooming down the road,
On my motorbike.
Hi-ho, the derry-o, off to work I go!
Someone needs my help,
I'm rushing to the scene,
Hi-ho, the derry-o, I am here to help!

Song 8

Oh, I jumped into my police car,
I'm zooming down the road.
Have my siren on and my lights flashing,
I'm going to save the day.

Song 9

A-B-C-D-E-F-G,
H-I-J-K-L-M-N-O-P,
Q-R-S, T-U-V,
W-X-Y and Z.

Song 10

1-2-3-4-5,
6-7 and 8,
9-10, let's count again.
I love to learn each day!

Song 11

Stop, stop, stop!
Go, go, go!
Rev my engine,
Zoom, zoom, zoom, zoom.
Off I go!

Song 12

Cruising around on my motorbike,
Driving through the town.
I shout hello, I wave good-bye,
To everyone I meet!

CARE & MAINTENANCE

1. Keep the unit clean by wiping it with a slightly damp cloth.
2. Keep the unit out of direct sunlight and away from direct heat sources.
3. Remove the batteries if the unit will not be in use for an extended period of time.
4. Do not drop the unit on hard surfaces and do not expose the unit to moisture or water.

TROUBLESHOOTING

If for some reason the unit stops working or malfunctions, please follow these steps:

1. Please turn the unit **Off**.
2. Interrupt the power supply by removing the batteries.
3. Let the unit stand for a few minutes, then replace the batteries.
4. Turn the unit **On**. The unit should now be ready to use again.
5. If the unit still does not work, install a new set of batteries.

IMPORTANT NOTE:

If the problem persists, please call our **Consumer Services Department** at **1-800-521-2010** in the U.S. or **1-877-352-8697** in Canada, or by going to our website at **vtechkids.com** and filling out our **Contact Us** form located under the **Customer Support** link. Creating and developing **VTech®** products is accompanied by a responsibility that we take very seriously. We make every effort to ensure the accuracy of the information, which forms the value of our products. However, errors sometimes can occur. It is important for you to know that we stand behind our products and encourage you to contact us with any problems and/or suggestions that you might have. A service representative will be happy to help you.

CAUTION

Changes or modifications not expressly approved by the party responsible for compliance could void the user's authority to operate the equipment.

NOTE

This equipment has been tested and found to comply with the limits for a Class B digital device, pursuant to Part 15 of the FCC Rules. These limits are designed to provide reasonable protection against harmful interference in a residential installation. This equipment generates, uses and can radiate radio frequency energy and, if not installed and used in accordance with the instructions, may cause harmful interference to radio communications. However, there is no guarantee that interference will not occur in a particular installation. If this equipment does cause harmful interference to radio or television reception, which can be determined by turning the equipment off and on, the user is encouraged to try to correct the interference by one or more of the following measures:

- Reorient or relocate the receiving antenna.
- Increase the separation between the equipment and receiver.
- Connect the equipment into an outlet on a circuit different from that to which the receiver is connected.
- Consult the dealer or an experienced radio/TV technician for help.

Supplier's Declaration of Conformity

Trade Name: VTech®
Model: 5294
Product Name 3-in-1 Step & Roll Motorbike™
Responsible Party: VTech Electronics North America, LLC
Address: 1156 W. Shure Drive, Suite 200
Arlington Heights, IL 60004
Website: vtechkids.com

THIS DEVICE COMPLIES WITH PART 15 OF THE FCC RULES. OPERATION IS SUBJECT TO THE FOLLOWING TWO CONDITIONS: (1) THIS DEVICE MAY NOT CAUSE HARMFUL INTERFERENCE, AND (2) THIS DEVICE MUST ACCEPT ANY INTERFERENCE RECEIVED, INCLUDING INTERFERENCE THAT MAY CAUSE UNDESIRED OPERATION.

CAN ICES-3 (B)/NMB-3(B)

**CLASS 1
LED PRODUCT**

**Visit our website for more
information about our products,
downloads, resources and more.**

vtechkids.com

**Read our complete warranty policy online at
*vtechkids.com/warranty***



TM & © 2020 VTech Holdings Limited.
All rights reserved.
Printed in China.
91-003840-000 (US) (CA)